



975/976 Series Notch Filters

ERI filters and combiners have served the broadcast industry for over 30 years. The basic building block of ERI's combiner and multiplexer system is the unique filter cavity. Only ERI offers an all copper and brass cylindrical cavity, where all internal components in the RF path are silver plated. The result is an extremely efficient (low loss) and stable filter.

Most ERI filters include a unique bellows temperature compensation assembly which maintains the filters performance from a cold start to normal operating temperature without causing high transmitter VSWR.

Only ERI filters incorporate a unique loop coupling design that allows more control over the filter pass band and offers performance superior to iris coupled cavities used by other manufacturers.

975/ 976 Series

FM Notch Filters

With good antenna sites scarce and tower costs staggering, radio stations tend to operate their antennas in close proximity to one another. With close frequency spacing possible, radiation coupling between antennas is unavoidable and can be quite high. Ideally, a radio station transmitter would transmit power on just its assigned channel. Unfortunately, due to undesired coupling, a product frequency may be radiated as well. This product frequency or emission may actually compete with a station existing on or near its frequency. The FCC regulates these emissions and they must be suppressed. ERI 975/976 Notch Filter may be arranged in a series to achieve reduction of multiple frequencies and/or greater attenuation of any frequency.

Features

- High stability temperature compensated cavities
- Copper/ brass construction with stainless steel hardware (critical components are silver plated)
- Easily assembled floor standing units (hardware for ceiling suspension available on request)
- Minor adjustment of cavity resonant frequency can be made during full power operation of the filter
- Filters may be arranged in series to achieve reduction of multiple frequencies and/or greater attenuation of any single frequency
- Each filter includes a built in temperature indicator
- 975/976 Notch Filters are ideally suited to isolate radio station transmitters and reduce product emission to acceptable levels.

Characteristics

	Pass/Notch Frequency Separation	
	800 kHz to 1 MHz	Greater than 1 MHz
Notch Frequency Suppression:	25 dB	40 dB
975 Through Power Handling:	20 kW	35 kW
976 Through Power Handling:	30 kW	100 kW
VSWR Typical:	1.07:1 ± 100 kHz	1.05:1 ± 150 kHz
Insertion Loss:	< 0.05 dB	< 0.03 dB
Frequency Stability ± 50 °F From Normal Operating Temperature:	± 10 kHz	± 10 kHz

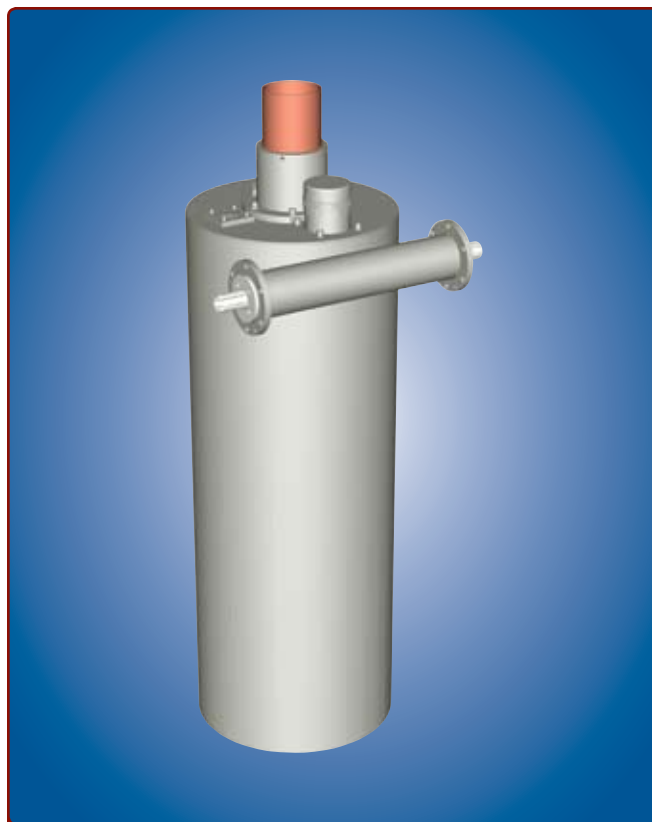

975 Series Filter Module

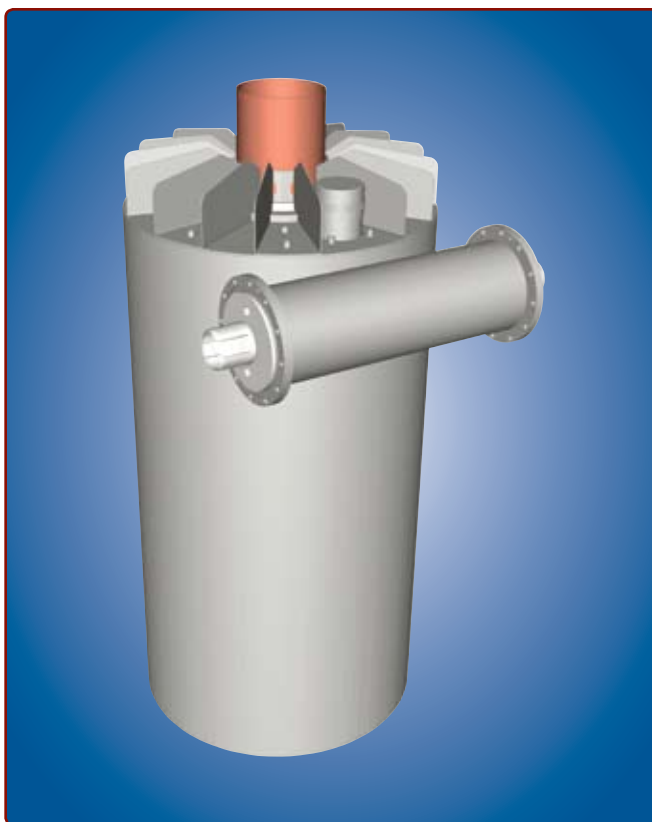

976 Series Filter Module

FM Filter and Combiner Systems